

# Soils Map

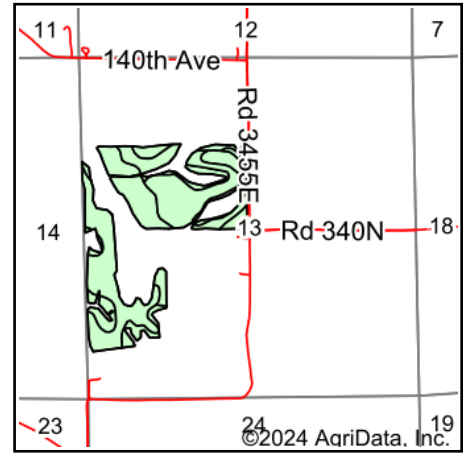

State: **Illinois**  
 County: **Pike**  
 Location: **13-7S-3W**  
 Township: **Spring Creek**  
 Acres: **88.07**  
 Date: **7/25/2024**

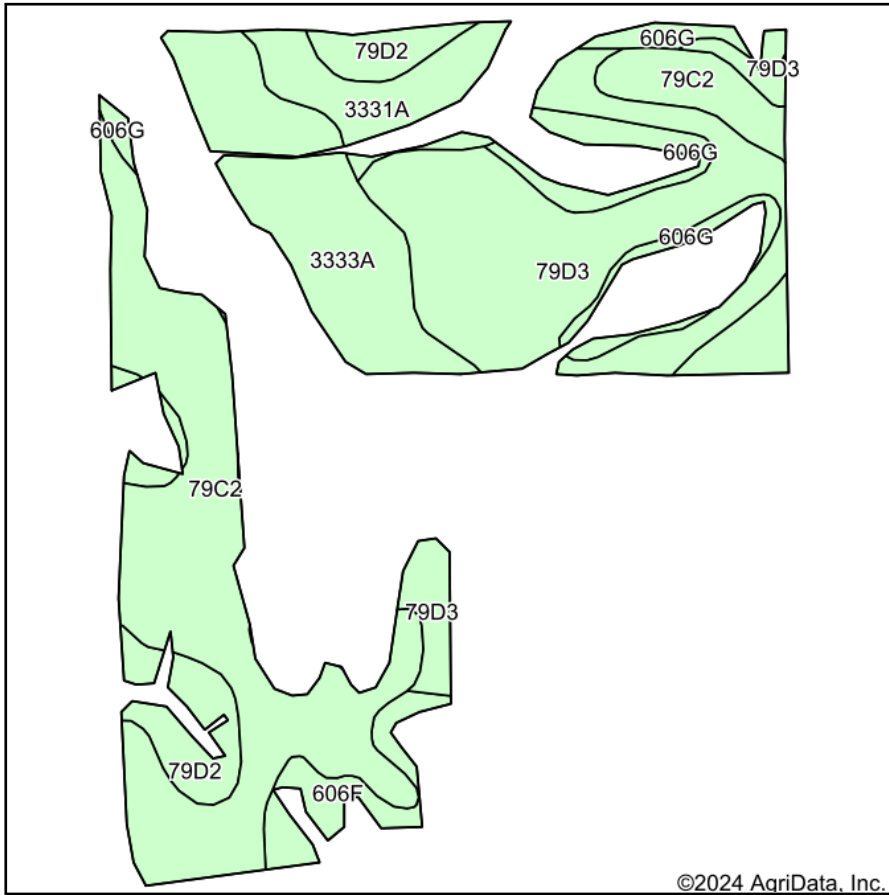

Maps Provided By:



Soils data provided by USDA and NRCS.

©2024 AgriData, Inc.

© AgriData, Inc. 2023

www.AgriDataInc.com

Area Symbol: IL149, Soil Area Version: 18

Code	Soil Description	Acres	Percent of field	Subsoil rooting a	Corn Bu/A	Soybeans Bu/A	Wheat Bu/A	Oats Bu/A b	Sorghum c Bu/A	Grass-legume hay, T/A	Crop productivity index for optimum management	*n NCCPI Soybeans
**79C2	Menfro silt loam, 5 to 10 percent slopes, eroded	30.60	34.7%	FAV	**153	**47	**59	0	**113	**4.60	**112	71
**79D3	Menfro silty clay loam, 10 to 18 percent slopes, severely eroded	23.06	26.2%	FAV	**129	**40	**49	0	**96	**3.90	**94	50
**3333A	Wakeland silt loam, 0 to 2 percent slopes, frequently flooded	13.44	15.3%	FAV	**157	**50	**61	**77	0	**4.60	**115	76
**79D2	Menfro silt loam, 10 to 18 percent slopes, eroded	6.46	7.3%	FAV	**144	**44	**55	0	**106	**4.30	**104	61
**606G	Goss gravelly silt loam, 35 to 60 percent slopes	5.80	6.6%	UNF	**37	**13	**13	**15	0	**1.30	**29	6
**3331A	Haymond silt loam, 0 to 2 percent slopes, frequently flooded	5.30	6.0%	FAV	**163	**50	**63	**83	0	**5.20	**119	80
**606F	Goss gravelly silt loam, 18 to 35 percent slopes	3.41	3.9%	UNF	**58	**21	**21	**23	0	**2.10	**45	6

Soils data provided by USDA and NRCS. Soils data provided by University of Illinois at Champaign-Urbana.



Code	Soil Description	Acres	Percent of field	Subsoil rooting <b>a</b>	Corn Bu/A	Soybeans Bu/A	Wheat Bu/A	Oats Bu/A <b>b</b>	Sorghum <b>c</b> Bu/A	Grass-legume <b>e</b> hay, T/A	Crop productivity index for optimum management	*n NCCPI Soybeans
<b>Weighted Average</b>					<b>136</b>	<b>42.3</b>	<b>52.1</b>	<b>18.6</b>	<b>72.2</b>	<b>4.1</b>	<b>99.5</b>	<b>*n 59.3</b>

**Table: Optimum Crop Productivity Ratings for Illinois Soil EFOTG are sourced from Bulletin 811 calculated Map Unit Base Yield Indices, and adjusted (Adj) for slope, erosion, flooding, and surface texture.** Publication Date: 02-08-2023

Crop yields and productivity (B811 EFOTG) are maintained at the following USDA web site: 2023 Illinois Soil Productivity and Yield Indices:

<https://efotg.sc.egov.usda.gov/#/state/IL/documents/section=2&folder=52809>

\*\* Base indexes from Bulletin 811 adjusted for slope, erosion, flooding, and surface texture according to the II. Soils EFOTG

**b** Soils in the southern region were not rated for oats and are shown with a zero "0".

**c** Soils in the northern region or in both regions were not rated for grain sorghum and are shown with a zero "0".

**e** Soils in the well drained group were not rated for grass-legume and are shown with a zero "0".

\*n: The aggregation method is "Weighted Average using all components"